

DIMENSIONAL DATA

All measurements are shown in inches.

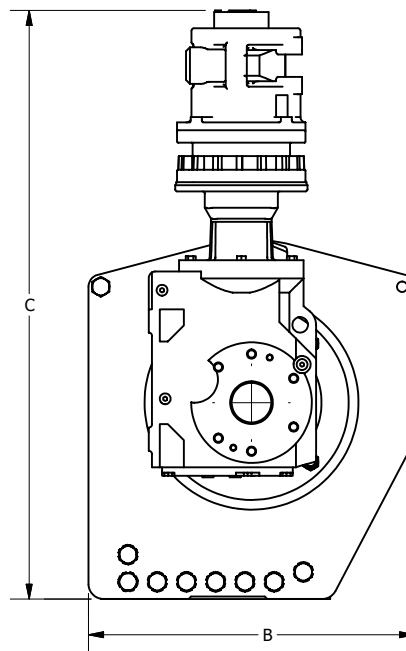
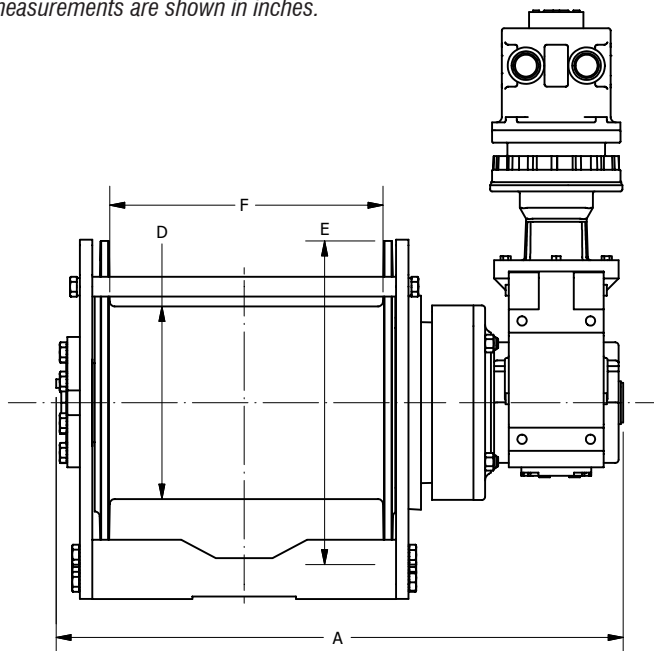

Drum Size	Dimensions						Wire Rope Capacity		
	A	B	C	D	E	F	1/2"	9/16"	5/8"
-02	27.6"	16.5"	29.8"	9.7"	16.4"	13.7"	547'	399'	368'
-04	27.3"	21.8"	32.0"	10.6"	20.0"	13.5"	957'	756'	589'
-05	27.6"	16.5"	29.8"	10.6"	16.5"	13.7"	470'	427'	300'

Typical dimensions shown; gearmotors can be rotated in 90° increments.

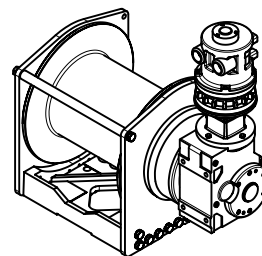

PERFORMANCE

Model	HP	Power Input		Calculated Line Pull / Line Speed					
		PSI	CFM	First Layer		Mean Drum		Full Drum	
				LBS	FPM	LBS	FPM	LBS	FPM
HL6000 ¹	6.5	80	215	6000	24	5000	29	4250	34
HL9000 ¹	6.5	85	225	9000	16	7500	19	6400	23
HL12000 ¹	6.5	80	215	12,000	12	9900	14	8450	16
HL15000 ²	6.5	85	225	15,000	9	12,625	11	10,870	13

¹ -02 drum performance

² -04 and -05 drum performance

CAUTION: The final determination as to the suitability of this product for any purpose is solely that of the user. Columbia products are not to be used to lift people or to lift anything over people.